

NEW PRODUCT

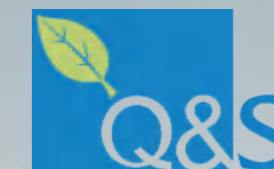

► **3 Advantages**
of Cjx2s Series Contactor



**More auxiliary contacts,
meet various application requirements**

9-95A with 1NO+1NC auxiliary contact,
help customer to optimize inventory



**Suitable for larger voltage fluctuation to
ensure the stable operation of the equipment**

Suit for 70%--120% voltage range, effectively avoid
the impact of power grid voltage fluctuations, can operate
smoothly under peak electricity.



**Super environment adaptability, can be
reliable operation with extreme environment.**

The ambient temperature from -35 °C to 70 °C ,
meet the application requirements of
all kinds of occasions.

Product Structure Analysis Diagram

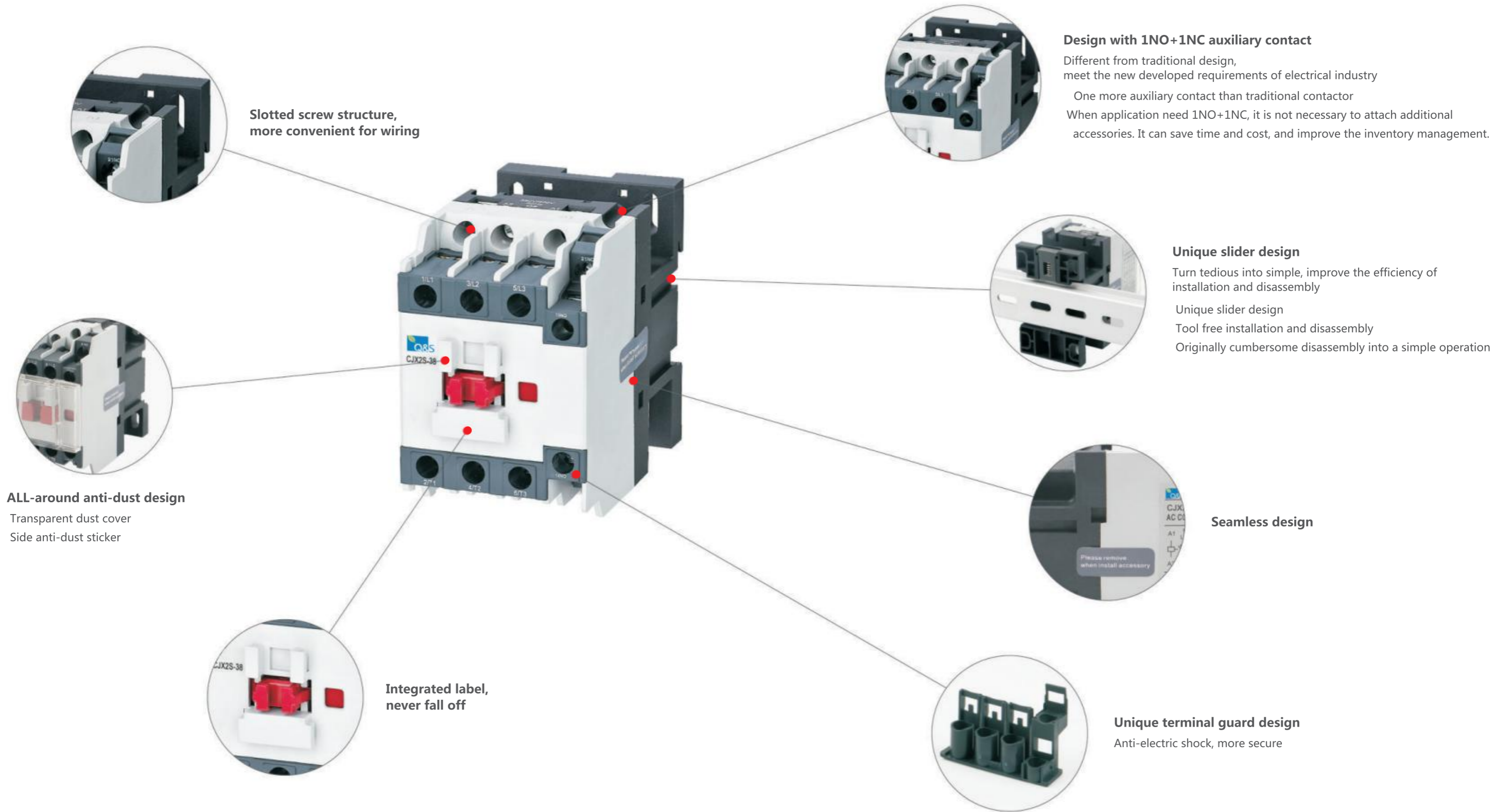

Product Overview

CJX2S series AC Contactor with novel appearance and compact structure is suitable for using starting & controlling the AC motor frequently, switching on and off the circuit at a long distance. It is used in combination with thermal relay to compose a magnetic motor starter.

Standard: IEC 60947-1, IEC 60947-4-1.

Specifications

- Rated operation current(Ie): 9-95A
- Rated operation voltage(Ue): 220V~690V
- Rated insulation voltage: 690V
- Poles: 3P
- Installation: Din rail and screw installation

Operating and Installation Conditions

Type	Operating and Installation Conditions
Installation category	III
Pollution level	3
Certification	CE, CB, CCC, TUV
Protection degree	CJX2S-09~38 IP20 CJX2S-40~95 IP10
Ambient temperature	limit of temperature: -35°C~+70°C, normal temperature: -5°C~+40°C The average no more than +35°C within 24 hours. If not in normal operating temperature range, please refer to "Instructions for abnormal environment"
Altitude	2000m
Ambient temperature	The maximum temperature of 70 degrees, the air relative humidity not exceed 50%, under lower temperature can allow for higher relative humidity. If the temperature is 20°C, the air relative humidity could up to 90%, Special measures should be taken for occasional condensation due to humidity changes.
Installation position	Inclination between installation surface and vertical surface should not exceed ±5°
Shock vibration	Products should be installed and used without significant shake, shock and vibration place.



Specifications

CJX2S Specifications

Appearance



Type	CJX2S-09 CJX2S-12 CJX2S-18 CJX2S-25 CJX2S-32 CJX2S-38 CJX2S-40 CJX2S-50 CJX2S-65 CJX2S-80 CJX2S-95													
Main circuit characteristic														
Poles	3P													
Rated insulation voltage(Ui)	V	690												
Rated operating voltage(Ue)	V	380/400, 660/690												
Rated thermal current(Ith)	AC-1	20	20	32	40	50	50	60	80	80	125	125		
Rated operation current(Ie)	AC-3,380/400V	A	9	12	18	25	32	38	40	50	65	80	95	
	AC-3,660/690V	A	6.6	8.9	12	18	22	22	34	39	42	49	49	
	AC-3,380/400V	A	3.5	5	7.7	8.5	12	14	18.5	24	28	37	44	
	AC-3,660/690V	A	1.5	2	3.8	4.4	7.5	8.9	9	12	14	17.3	21.3	
Rated operational power(Pe)	AC-3,380/400V	kW	4	5.5	7.5	11	15	18.5	18.5	22	30	37	45	
	AC-3,660/690V	kW	5.5	7.5	10	15	18.5	18.5	30	33	37	45	45	
	AC-3,380/400V	kW	1.5	2.2	3.3	4	5.4	5.5	7.5	11	15	18.5	22	
	AC-3,660/690V	kW	1.1	1.5	3	3.7	5.5	6	7.5	10	11	15	18.5	
Mechanical life		1200			1000			900			650			
Electrical life	AC-3	10000 times	110			90			65					
	AC-4		22			17			11					
Frequency of operation	AC-3	times/hour	1200			600								
	AC-4		300			300								
Connecting capability of main circuit terminal														
Flexible wire	1 wire	mm ²	1...4			1.5...6			2.5...25			4...50		
	No terminal	2 wire	1...4			1.5...6			2.5...16			4...25		
Flexible wire	1 wire	mm ²	1...4			1...6			2.5...25			4...50		
	With terminals	2 wire	1...2.5			1...4			2.5...10			4...16		
Hard wire	1 wire	mm ²	1...4			1.5...6		1.5...10		2.5...25			4...50	
	No terminal	2 wire	1...4			1.5...			2.5...10			4...25		
Fastening torque	N·m	1.2			1.8			5			9			
Coil														
Rated control voltage(Us)	50Hz	V	24 36 48 110 127 220/230			240 380/400 415 440								
	50/60Hz	V	24 36 48 110 127 220/230			240 380/400 415 440								
Allowed control circuit voltage(Us)	Operation	V	Installation inclination angle ±22.5°: 85%~110%Us						Installation inclination angle±5°: 70%~120%					
	Release	V	Installation inclination angle ±22.5°: 20%~75%Us						Installation inclination angle±5°: 20%~65%					
Power consumption of coil	Actuation	VA	60			70			200			200		
	Keep	VA	6-9.5			6-9.5			15-20			15-20		
	Consumption	W	1-3			1-3			6-10			6-10		
Auxiliary contacts														
Auxiliary contacts specification	A	11												
Rated thermal current (Ith)	A	10												
Rated operating voltage (Ue)	AC	V	380											
	DC	V	220											
Rated control capacit	AC-15	VA	360											
	DC-13	W	33											
Certification	CCC, CE, TUV, CB													

Overall and Mounting

CJX2S-09~38

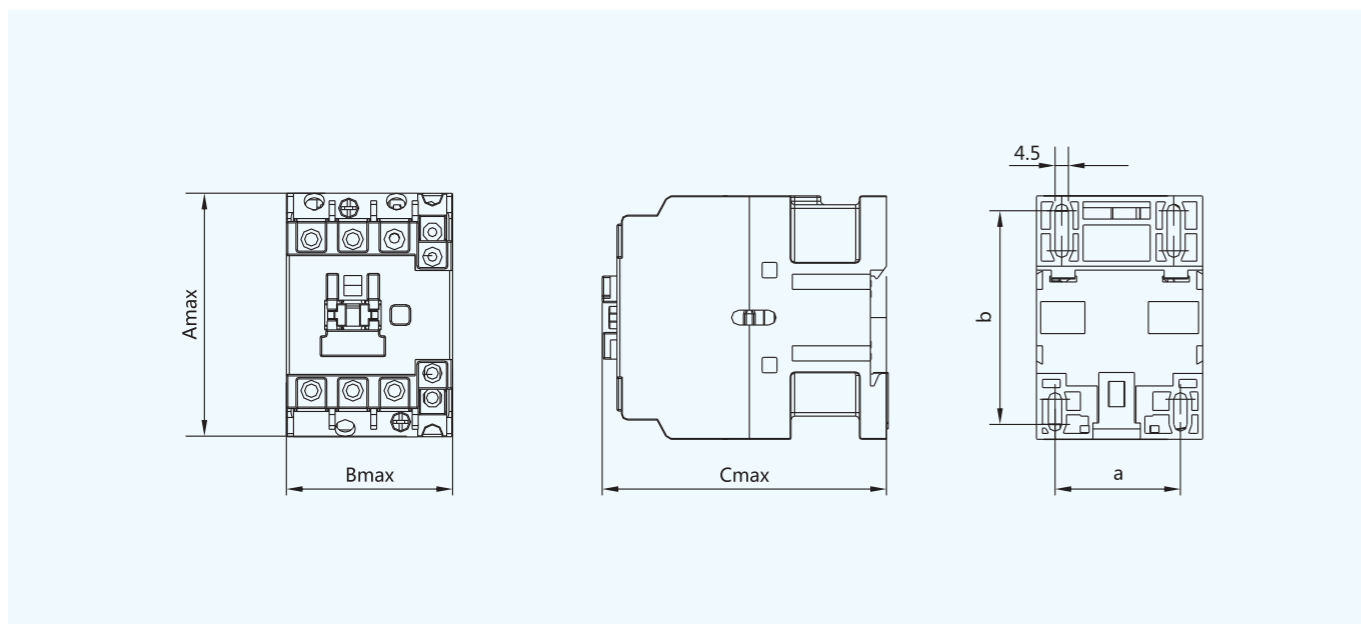

CJX2S-40~95

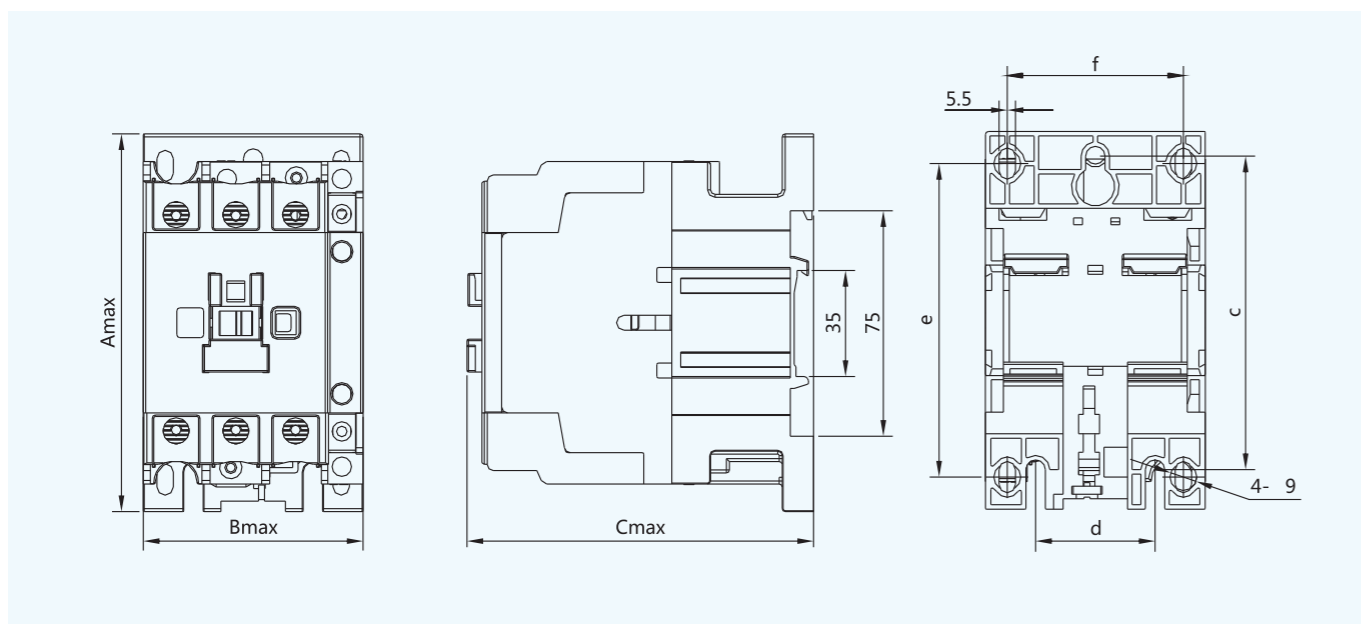

Type	Amax	Bmax	Cmax	a	b	c	d	e	f
CJX2S-09, 12, 18	74.5	45.5	85.5	35	50/60	-	-	-	-
CJX2S-25, 32, 38	83	56.5	97	40	50/70	-	-	-	-
CJX2S-40, 50, 65	127.5	74.5	117	-	-	105	40	100/110	59
CJX2S-80, 95	127.5	85.5	125.5	-	-	105	40	100/110	67